

DETAIL-1

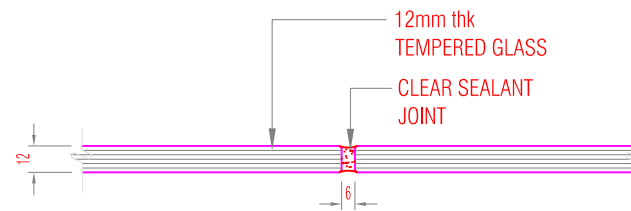

DETAIL-2

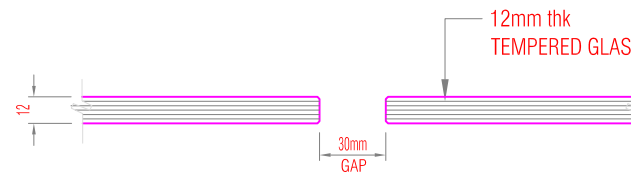

DETAIL-2a (OPTIONAL)

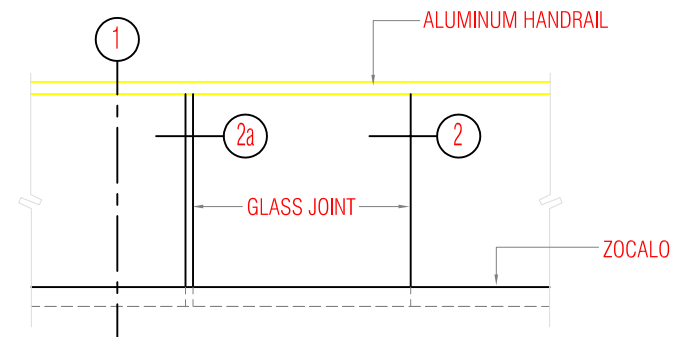

ELEVATION



4th Floor 115 Y - L Building  
Rufino Corner Salcedo Street,  
Legazpi Village, Makati City

Phone: (632) 892-8437  
Facsimile: (632) 893-9867

Subject: GLASS BALUSTRADE DETAILS

Drawn by: RTA	Date:	Drawing No.	REVISION:
Checked by: CS	Scale: 1 : 4	A4	GB / 300

SEAPAC PHILIPPINES, INC. THESE DESIGN DRAWING AND THE COPYRIGHT THERE IN ARE PROPERTY OF SEAPAC PHILIPPINES INC. AND MUST NOT BE DIVULGED REPRODUCED OR COPIED WITHOUT WRITTEN PERMISSION.