

DETAIL-3

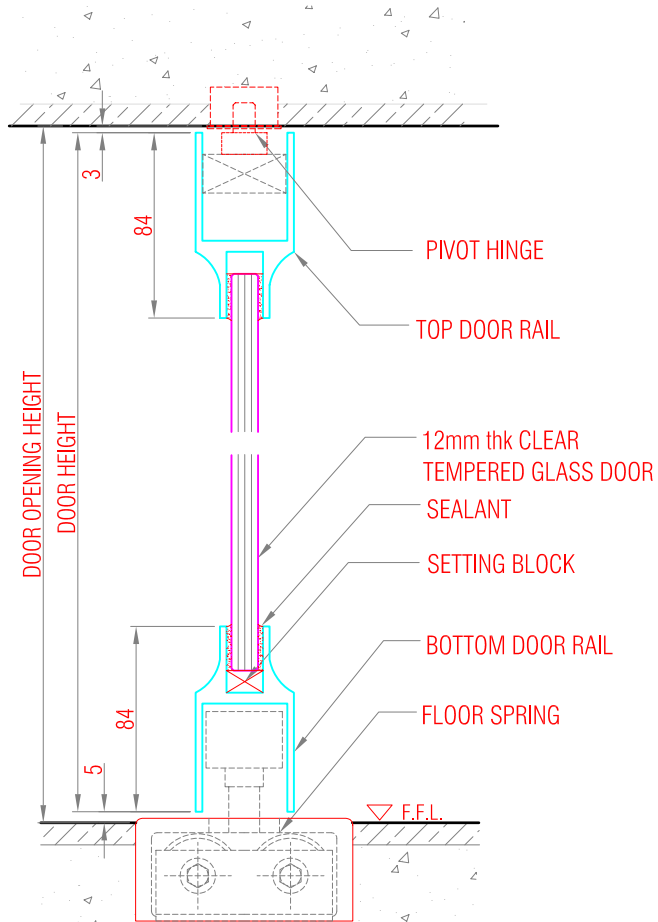

DETAIL-1

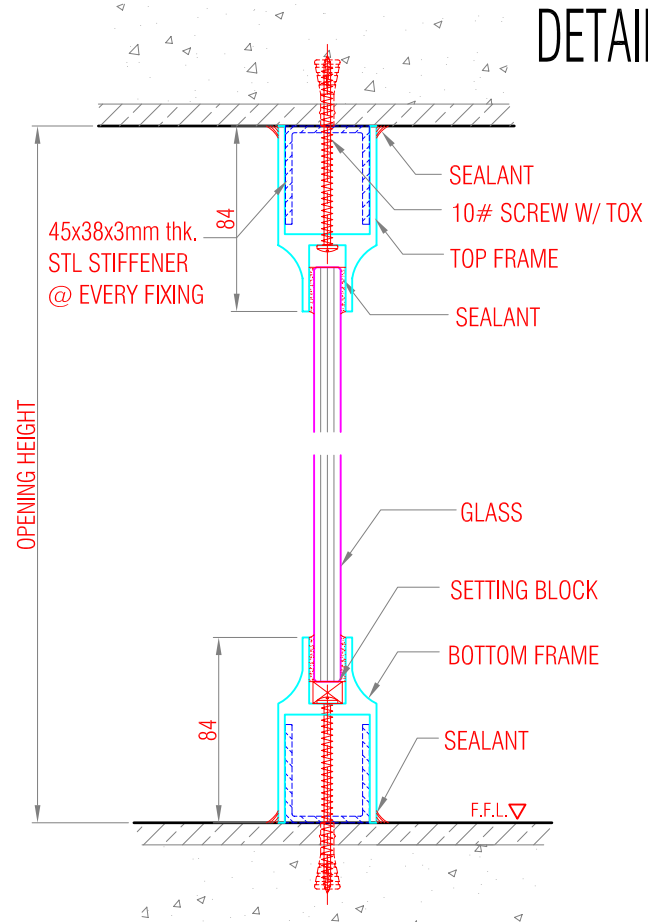

DETAIL-2

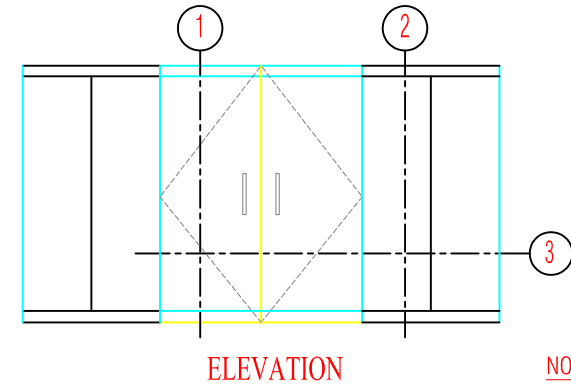

NOTE:
DOOR HANDLE-TO SUIT
CUSTOMER DESIGN



4th Floor 115 Y - L Building
Rufino Corner Salcedo Street,
Legazpi Village, Makati City

Phone: (632) 892-8437
Facsimile: (632) 893-9867

Subject: FRAMELESS GLASS DOORS W/ TOP & BOTTOM RAIL, DOUBLE LEAF

Drawn by: RTA	Date:	Drawing No. FG / 301	REVISION: -
Checked by: CS	Scale: 1 : 4	A4	

SEAPAC PHILIPPINES, INC. THESE DESIGN DRAWING AND THE COPYRIGHT THERE IN ARE PROPERTY OF SEAPAC PHILIPPINES INC. AND MUST NOT BE DIVULGED REPRODUCED OR COPIED WITHOUT WRITTEN PERMISSION.